



CITY OF ORANGE

PUBLIC WORKS DEPARTMENT

www.cityoforange.org

ENGINEERING DIVISION
(714) 744-5544
FAX: (714) 744-5573

MAINTENANCE DIVISION
(714) 532-6480
FAX: (714) 532-6444

TRAFFIC DIVISION
(714) 744-5540
FAX: (714) 744-5573

WATER DIVISION
(714) 288-2475
FAX: (714) 744-2973

Addendum No. 1

Date: November 30, 2023

To: All Bidders

Subject: **Bid No. 23-24.18**; SP-4269; CDBG ADA Wheelchair Access Ramp Replacement Project

The following updates and revisions are made to the project referenced above.

Mandatory Virtual Pre-Bid Meeting:

A virtual Microsoft Teams pre-bid meeting to review CDBG funding requirements is scheduled for December 7, 2023 at 2:00 PM accessible from the meeting link below:

https://teams.microsoft.com/l/meetup-join/19%3ameeting_MzE2NWUyZDAtMDY4ZC00ZGNiLThkMjYtNjdjNGM2OTZlNDgw%40thread.v2/0?context=%7b%22Tid%22%3a%22b49e2edd-48c0-4b57-bb97-0d939ef296b1%22%2c%22Oid%22%3a%2224ab8bc6-e077-40a3-8c01-00d905fc2a4e%22%7d

Meeting ID: 251 228 742 001

Passcode: jtMBb2

Proposal Schedule:

1. Items 2 and 3 on Proposal Schedule revised to include tree trunk sizes.

Plans:

1. Plan sheet revised to include photos of the existing trees to be removed and tree trunk sizes.

Special Provisions:

1. Page SP-32: Correction to payment clause for “Remove and Dispose Existing Trees and Root Systems”

Bidder shall signify the receipt of this addendum with signature on page **P-4** of the project's bid proposal. Please contact Martin Varona for any questions regarding this addendum by 10:00 AM December 7, 2023 at mvarona@cityoforange.org or call at (714) 744-5563.

A handwritten signature in black ink, appearing to read "Martin Varona", written over a horizontal line.

Martin Varona, P.E.
Associate Civil Engineer
Public Works – Engineering

Cc: Randy Nguyen

PROPOSAL SCHEDULE
CDBG FY23-24 ADA Wheelchair Access Ramp Replacement
(Bid No. 23-24.18; SP-4269)

ITEM NO.	QUANTITY	UNIT PRICE TO BE WRITTEN IN WORDS	UNIT PRICE	TOTAL
1	8 EA	Sawcut, Remove, and Replace Wheelchair Access Ramp with Truncated Domes per City Std. 121		
		_____ dollars		
		and _____ cents	_____	_____
2 (D)	1 EA	Remove and Dispose of Existing Tree and Root System at Southwest Corner of Quincy and Grand. (Two Trunks at 20" Diameter Each)		
	ADD-1			
		_____ dollars		
		and _____ cents	_____	_____
3 (D)	1 EA	Remove and Dispose Existing Tree and Root Systems at Northwest Northeast Corner of Jacaranda and Grand. (4" Trunk Diameter)		
	ADD-1			
		_____ dollars		
		and _____ cents	_____	_____

TOTAL BID AMOUNT _____

TOTAL BID AMOUNT WRITTEN IN WORDS:

LEGEND OF UNITS

EA= each D = Deleteable Item

Contractor shall utilize mechanical equipment and hand operated equipment to compact A.C. base paving adjacent to concrete removals. Pavement shall be compacted in lifts not to exceed 4" and compacted to 95% compaction.

Sidewalk shall be saw cut along and removed at the nearest scoring line or joint for the full width of sidewalk. No section of driveway to be removed or replaced shall be less than 6 feet in width.

300-1.3.2(c) Tree Roots

Clearing and grubbing for sidewalk shall include removal of all tree roots in excess of one-half (12mm) inch diameter to minimum depth of six (150 mm) inches below sidewalk subgrade prior to placing concrete. **Prior to removal of tree roots in excess of 3 (72 mm) inches in diameter, the City Tree Services Coordinator will be contacted to determine need for removal. Should the arborist determine that root removal would impair the health or structural stability of the tree, the contractor will allow sufficient time for removal of the tree by the City.** Imported backfill shall be placed and compacted to fill any voids created when roots are removed.

300-1.4 Payment

No separate bid item is provided for **CLEARING AND GRUBBING** and the payment shall be considered in the bid item for removal of specified items of work.

Payment for **REMOVE EXISTING ASPHALT CONCRETE PAVEMENT** shall be Paid by under **UNCLASSIFIED EXCAVATION**. No additional compensation will there be allowed therefore.

Payment for **SAWCUT** as shown on the project plans shall be included in the various unit bid prices where this work is required and shall include all labor tools, equipment and materials required to complete the work. No additional compensation will there be allowed therefore.

Payment for **REMOVE AND DISPOSE EXISTING TREES AND ROOT SYSTEMS** shall be paid ~~per the lump sum~~ at-a unit bid price per each tree removal and must be disposed per Section 300-1.3.1.1.

ADD-1

300-2 UNCLASSIFIED EXCAVATION:

In addition to those items specified in Section 300-2.1, unclassified excavation shall include all grading, shaping, excavation, compacting, or consolidating or other work that is needed to establish roadway subgrade within the project area.

Removal of existing A.C. pavement roadway section shall be included as unclassified excavation.

300-2.2a Unstable Subgrade in Roadway Excavation

When unstable subgrade material is first encountered, the Contractor shall use lightweight equipment to complete the excavation, hauling, rough and fine grading, laying of fabric, and placing of base material. The Engineer shall approve one of the following prior to continued excavation:

Alternate No. 1:

- 1) Over excavate subgrade 12" below recommended structural section.
- 2) Place geofabric and pin fabric at 6' (max) on centers from the edges inward with 8" steel, hooked pins. See Section 300-10.1.1 for fabric placement.
- 3) Place 12" of ¾" aggregate base material using lightweight equipment per Section 300-10.1.1.
- 4) Place recommended street structural section.
- 5) Contractor shall minimize wheel load repetitions by using track vehicles and steel wheeled rollers.
- 6) Base and sub-base material shall be compacted to 90% relative compaction.

Alternate No. 2:

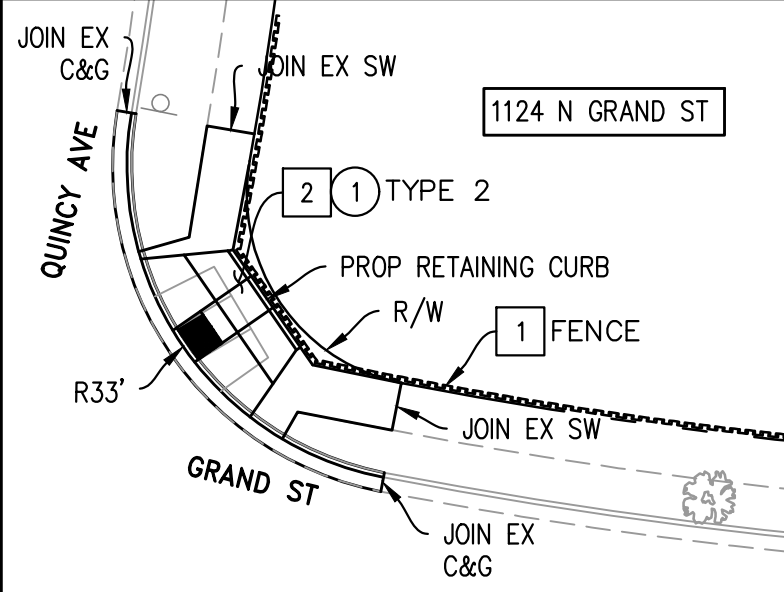
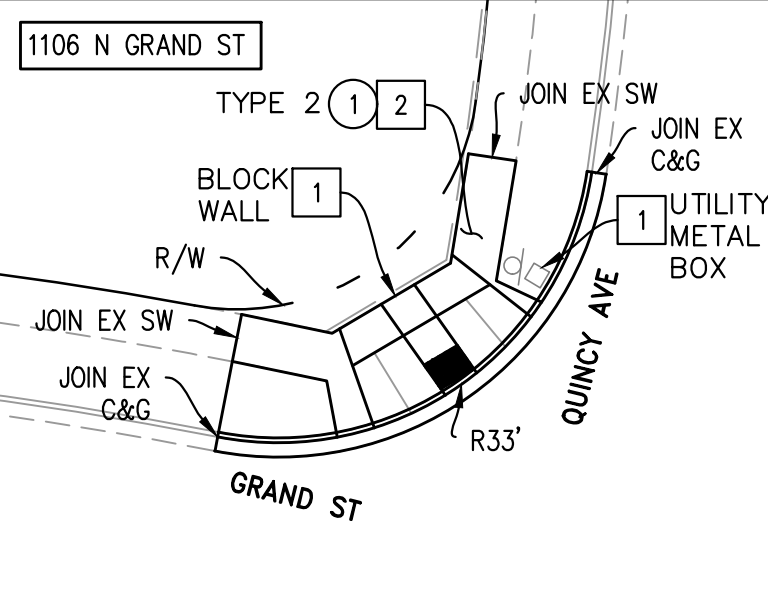
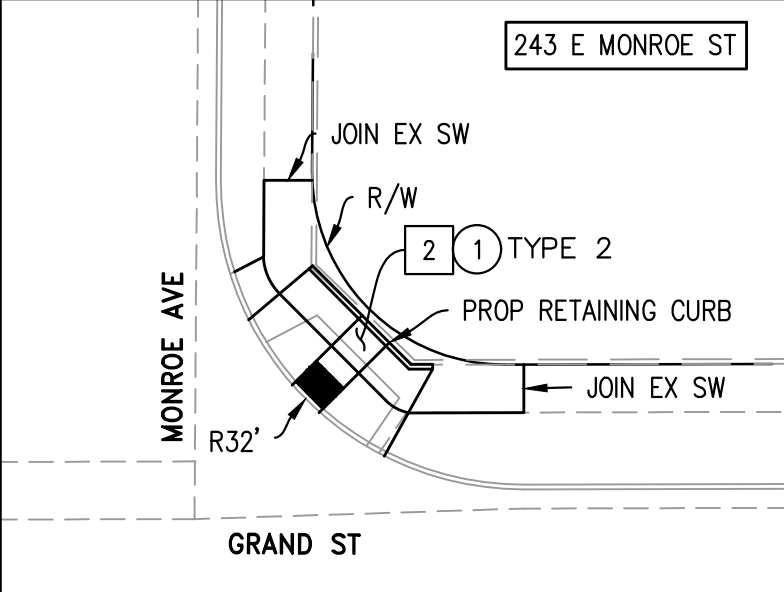
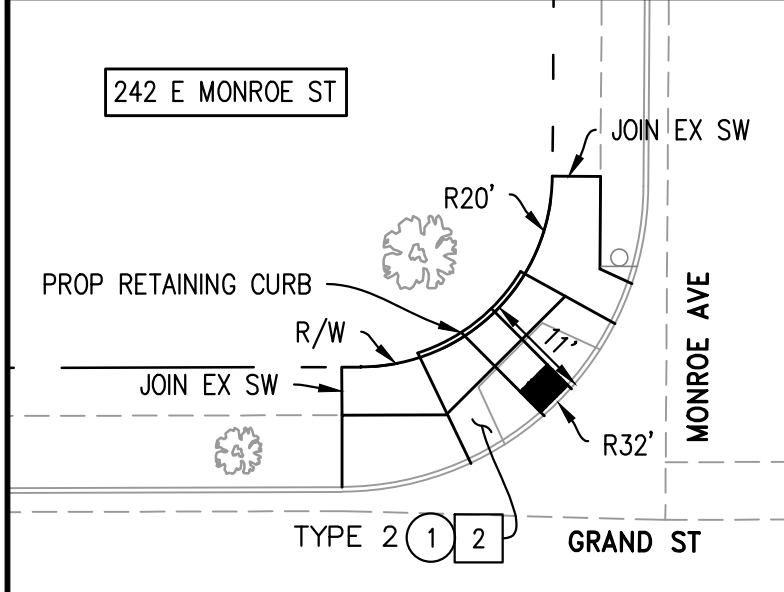
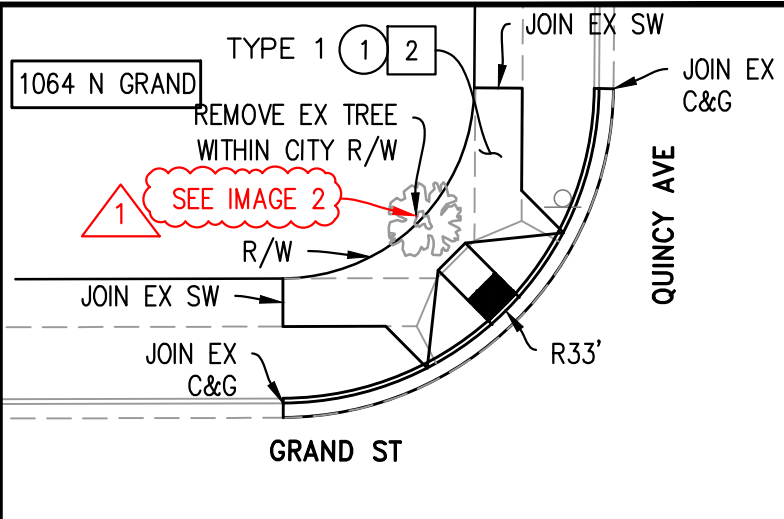
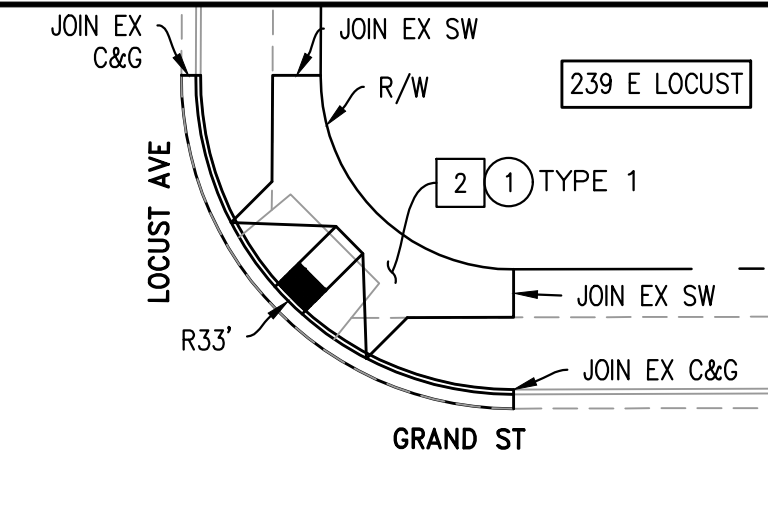
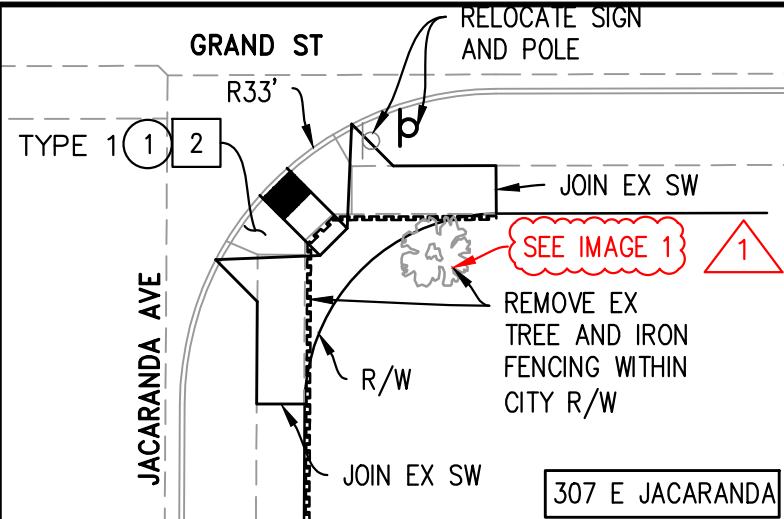
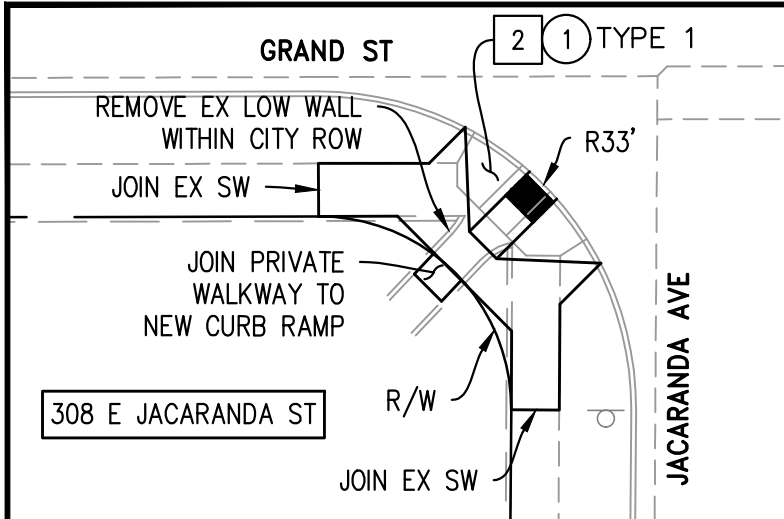

CONSTRUCTION NOTES

- ① CONSTRUCT ACCESS RAMP WITH TRUNCATED DOMES PER CITY OF ORANGE STD 121.

DISPOSITION NOTES

- 1 PROTECT IN PLACE.
- 2 REMOVE ACCESS RAMP.

ADDITIONAL NOTES

1. ALL RAMPS SHALL BE COORDINATED AND VERIFIED IN THE FIELD WITH CITY INSPECTOR PRIOR TO RAMP CONCRETE POUR.
2. CURB RAMP LAYOUTS PROVIDED HEREON ARE BASED ON AS-BUILT PLANS AND AERIAL IMAGING. CONTRACTOR SHALL VERIFY EXISTING CONDITIONS IN THE FIELD WITH THE CITY INSPECTOR AND NOTIFY THE CITY OF ANY VARIATIONS FROM THIS PLAN.
3. ALL ACCESS RAMPS SHALL BE RECONSTRUCTED BY HORIZONTAL SAWCUT METHOD, UNLESS SPANDREL OR CURB AND GUTTER IS SPECIFIED TO BE RECONSTRUCTED.



IMAGE 1: EXISTING TREE AT 307 E JACARANDA
4" DIAMETER TRUNK



IMAGE 2: EXISTING TREE AT 1064 N GRAND
20" DIAMETER TRUNKS (BOTH SAME SIZE)



ADDENDUM 1: ADDED PHOTOS OF TREES TO BE REMOVED AND TRUNK DIAMETERS FOR EACH.

LEGEND

- C&G = CURB AND GUTTER
- EX = EXISTING
- PROP = PROPOSED
- R/W = RIGHT OF WAY

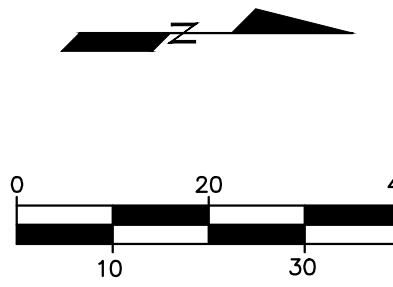

SCALE: 1"=20'

CITY OF ORANGE
OFFICE OF THE CITY ENGINEER

IMPROVEMENTS PLAN
CDBG FY23-24 ADA RAMP REPLACEMENT
RAMP DETAILS

DRAWN	M.VARONA	11/2/23	SCALE: HORIZ. AS NOTED VERT. AS NOTED	F.B. _____	PG. _____	SHEET 1 OF 1 SHEETS
DESIGNED	M.VARONA	11/2/23				
CHECKED	Y.NAKAGAWA	11/6/23				

N:\Public Works\ENGINEERING\Design\Projects\SP-4289_CDBG ADA Ramp Replacement\FY 23-24\01_Engineering\Drawings\SP-4289_Plan.dwg
 By: Martin Varona on 11/27/2023 2:25 PM